



THAME WORKHOLDING

Field End, Thame Road
Long Crendon, Aylesbury
Bucks HP18 9EJ, England

Tel: 01844 208050

Email: sales@thameworkholding.com



Chuck Type:
KITAGAWA B 15

Fax: 01844 201699

Web: www.thameworkholding.com

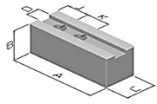

Type AS, AA

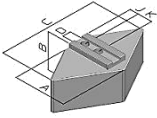

Type DS, DA

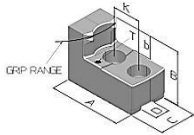
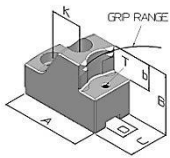

Type A

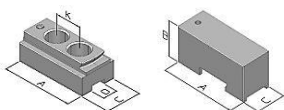
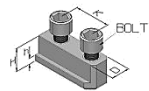

Master

Top Jaws

Serrated Soft Top Jaws 1.5x60°				Slot: 22mm	T-Nut to suit GP15	
Jaw Type	A	B	C	Kg/Set	Material	Part No.
AS	165	80	60	15.2	080M15	BO15
AS	165	100	60	19.0	080M15	BC15
AS	165	125	60	24.0	080M15	DJ15
AS	145	100	100	28.0	080M15	BE15

Full Wrap Top Jaws 1.5x60°						
DS	152	76	280	48.0	080M15	CN38
DA	152	76	280	16.0	Aluminium	HN38
DA	152	100	280	21.1	Aluminium	HN39

Adjustagrip Hard Jaws - External Clamping			T-Nut to suit GP15	
B	C	b		
79	60	33		
Gripping Ranges				
50-108mm			590M17	LF05
99-162mm			590M17	LF10
160-224mm			590M17	LF16
220-285mm			590M17	LF22
279-345mm			590M17	LF28
339-404mm			590M17	LF34

Adjustagrip Hard Jaws - Internal Clamping				
B	C	b		
79	60	33		
Gripping Ranges				
100-162mm			590M17	MF10
160-224mm			590M17	MF16
222-287mm			590M17	MF22
280-345mm			590M17	MF28

Hard Reversible Top Jaws						
A	B	C	S1	S2		
140	90	60	22	22	590M17	GT15

T-Nuts					
D	H	h	K		
22	45.5	16.5	43	817M40	GP15

Height Pins for Adjustagrips			
H	WAF	Thread	
5	13	M8	IU05
10	13	M8	IU10
15	13	M8	IU15
20	13	M8	IU20
25	13	M8	IU25

Quick Change Jaws						
	A	B	C	K		
Master	116	45	63.5	43	590M17	QK15
Standard	130	80	60		080M15	QS15

Thame Workholding also design and manufacture jaws to suit your specific workpieces.

© Thame Workholding 2013